

DEDDF RHEOLEIDDIO TRAFFIG FFYRDD 1984
ADRAN 14(1)(a) (FEL Y'I DIWYGIWYD)

NEWMAN ROAD, TREVETHIN, PONT-Y-PŴL

GORCHYMYN GWAHARDD TRAFFIG DROS DRO 2024

HYSBYSIR trwy hyn fod Cyngor Bwrdeistref Sirol Torfaen, drwy arfer ei bwerau o dan Ddeddf Rheoleiddio Traffig Ffyrdd 1984 (fel y'i diwygiwyd) wedi gwneud Gorchymyn, bydd yn gwahardd unrhyw draffig rhag teithio ar hyd rhan o Newman Road, Pont-y-pŵl.

Mae'r llwybr amgen ar hyd West Hill Road, Orchard Close, Glen View Road ac i'r gwrthwyneb. (Cedwir mynediad i drigolion a'r gwasanaethau argyfwng cyn belled ag y bo modd yn rhesymol).

Mae'r gwaharddiad yn ofynnol am fod gwaith yn cael ei wneud, neu ar fin cael ei wneud, ar yr heol, neu ger yr heol, i adnewyddu polyn pren.

The Order will operate from time and date 2023 to time and date 2023 for ? days and any other days deemed necessary within a period not exceeding 18 months.

Dyddiad: ????

Stephen Vickers, Prif Weithredwr, Y Ganolfan Ddinesig, Pont-y-pŵl, Torfaen, NP4 6YB

ROAD TRAFFIC REGULATION ACT 1984
SECTION 14 (1)(a) (AS AMENDED)

NEWMAN ROAD, TREVETHIN, PONTYPOOL

TEMPORARY PROHIBITION OF TRAFFIC ORDER 2024

NOTICE is hereby given that the County Borough Council of Torfaen in exercise of their powers under the Road Traffic Regulation Act 1984 (as amended) have made an Order the effect of which will be to prohibit any traffic from proceeding along a section of Newman Road, Trevethin, Pontypool.

The alternative route is along West Hill Road, Orchard Close, Glen View Road and viceversa. (Access for residents and emergency services will be maintained as far as is reasonably practicable).

The prohibition is necessary because works are being or are proposed to be executed on or near the road to renew a wooden pole.

Bydd y Gorchymyn yn weithredol o ddydd Sul 20 Hydref 2024 i ddydd Sul 20 Hydref 2024 am 1 diwrnod ac unrhyw ddiwrnodau eraill yr ystyrir eu bod yn angenrheidiol o fewn cyfnod nad yw'n fwy na 18 mis.

Dated: 16th Hydref 2024.

Stephen Vickers, Chief Executive, Civic Centre, Pontypool, Torfaen, NP4 6YB

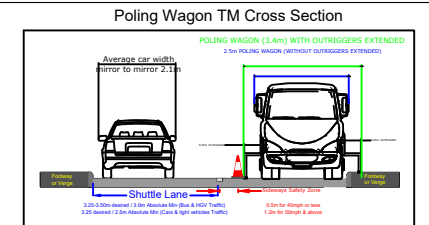
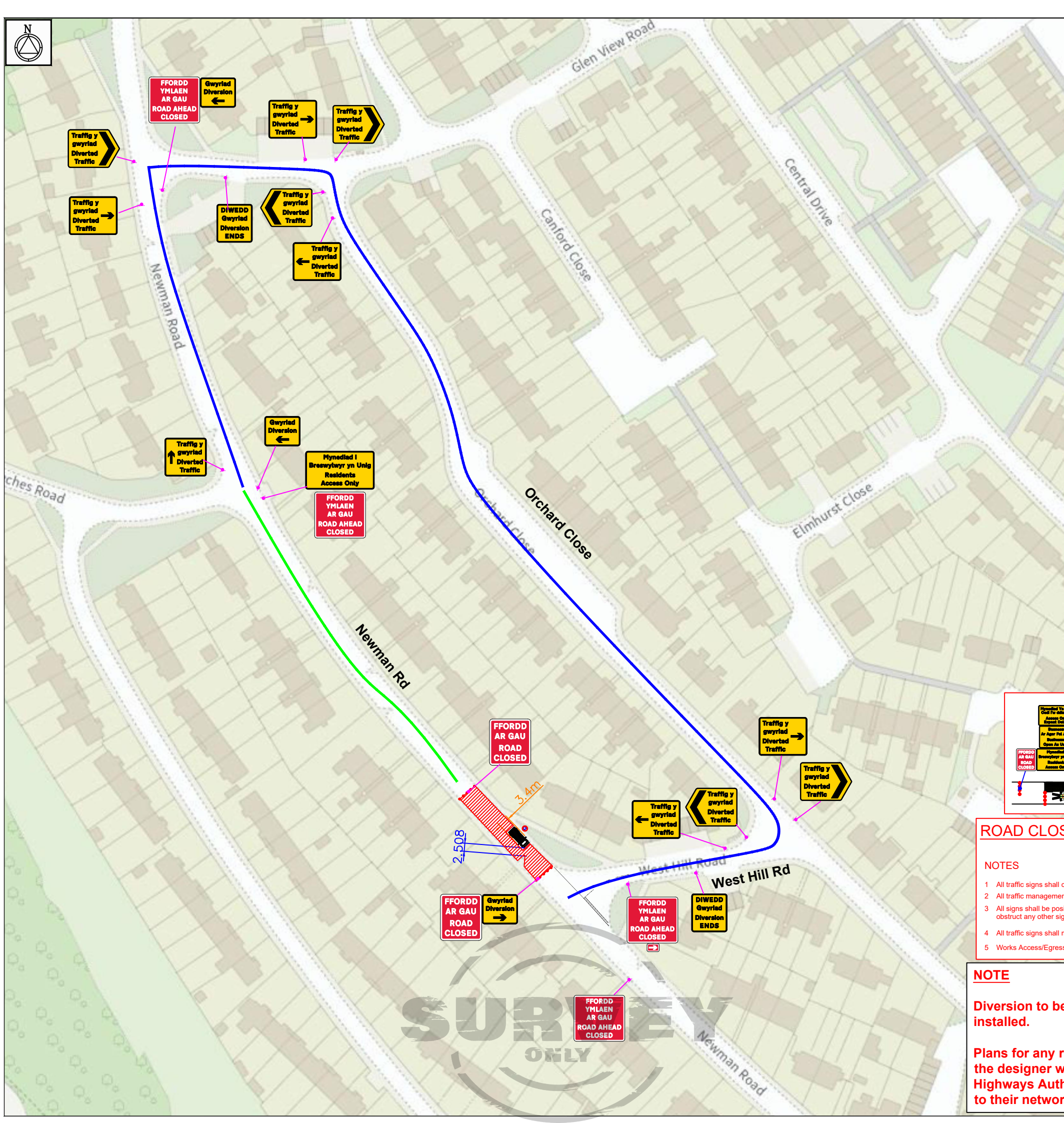

Scan QR code for directions

Grid Ref:
327712 , 202351



DETAIL B

Single/Dual carriageway 40mph or less - 450mm traffic cones, spacing 1.5m.
Single/Dual carriageway 50mph or more - 750mm traffic cones, spacing 1.5m.
Dual carriageway national speed limit - 750mm traffic cones, spacing 1.5m, relaxation 3m.

Notes:
1) During darkness, warning lights to BS EN 12352:2006 should be provided in accordance with Table A1.3 (Appendix 1).
2) 45° tapers have 1.5m spacing, no relaxations.
3) On motorways and NSL AP duals with hard shoulders, 1m cones will be required for both standard and relaxation works for lead tapers and the facing wall of lane changes.

DETAIL C2

Single carriageway 40mph or less - 450mm traffic cones.
Single/Dual carriageway 50mph or more - 750mm traffic cones.

Notes:
1) During darkness, warning lights to BS EN 12352:2006 should be provided in accordance with Table A1.3.

KEY

	Works Area		Closure Area
	Diversion Route		Temporary Pedestrian Crossing
	Pedestrian Route		Sign
	Pedestrian Barriers		No Parking Cones
	TM Operative		Marshal



Client
openreach

Works Description
REPLACE POLE

Address
USRN: 40800634, Newman Road, Penygarn, Trevethin, Pontypool, Torfaen, Wales, NP4 8HF

TM Type
ROAD CLOSURE DIVERSION 24 SIGNS

Design: M.CARR	Drawn: M.CARR	Chkd: P.MATHER
Date: 29/02/24	Date: 29/02/24	Date: 29/02/24
Scale: NTS	Status: DRAFT	

Drawing No
67-1900-MJQ2024-0567 - WF9CPV2R - PONTYPOOL - 50-4000

Road Speed

Qty: 1 Ref: 13-9-RAR Direction to hazard Right	
Qty: 2 Ref: 13.9 Diversion Left	
Qty: 1 Ref: 13.9 Diversion Right	
Qty: 2 Ref: 13.9 Diversion ENDS	
Qty: 2 Ref: 13.9 Diverted Traffic Left Ahead	
Qty: 2 Ref: 13.9 Diverted Traffic Left	
Qty: 2 Ref: 13.9 Road Closed	
Qty: 1 Ref: 13.9 Residents Access Only	
Qty: 4 Ref: 13.9 Road Ahead Closed	
Qty: 3 Ref: 13.9 Diverted Traffic Right Ahead	
Qty: 3 Ref: 13.9 Diverted Traffic Right	
Qty: 1 Ref: 13.9 Diverted Traffic Straight	

Advance warning signs to be installed prior to installation of closure.



ROAD CLOSURE :

- NOTES
- All traffic signs shall comply with Chapter 8 of the Traffic Signs Manual
 - All traffic management equipment shall be provided by the Contractor, unless otherwise specified.
 - All signs shall be positioned so as not to be obscured by any other objects and shall not obstruct any other sign, permanent or temporary as much as is reasonably practicable.
 - All traffic signs shall meet the reflectorisation requirements of BS 873 : Part 6 : 1983, Table 1.
 - Works Access/Egress to be positioned to suit ongoing works.

NOTE
Diversion to be driven prior to the road closure being installed.
Plans for any road closure should be discussed by the designer with the police and any relevant Highways Authorities, if traffic is being diverted on to their network.